

ITEM	DESCRIPTION	QTY
1	BOLT, 3/8-16 x 7/8	28
2	WASHER, Lock, 3/8	20
3	NUT, Flange, 3/8-16	16
4	SCREWS, Equipment, 12-24	30
5	MEMBER, Upper Adjustment	2
6	MEMBER, Lower Adjustment	2
7	MEMBER, Lower Cross	2
8	MEMBER, Upper Cross	2
9	UPRIGHTS, Aluminum	4

Figure 1.

1. INTRODUCTION

This instruction sheet provides assembly procedures for the 4-Post Adjustable 762-914.4 mm [30-36 in.] Aluminum Frame 1933570-1.

Component parts required to assembly the frame are shown in Figure 1.

To obtain information on AMP NETCONNECT products, visit our website at www.CommScope.com.



To reduce risk of injury, or damage to equipment, the rack must be properly secured to the floor.



To reduce risk of injury, or damage to equipment, do NOT install equipment in the rack until properly secured to the floor.

2. ASSEMBLY PROCEDURES

2.1. Frame Assembly

1. Fasten the Lower Cross Member to lower portion of rack rail. See Figure 2.

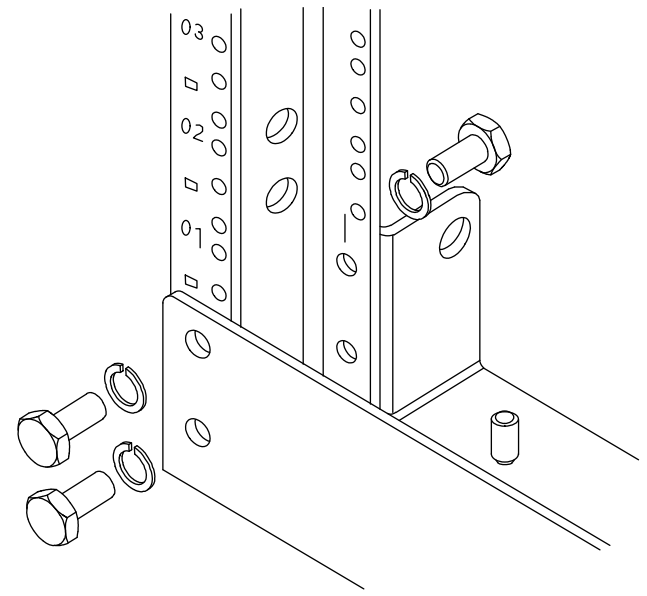

Figure 2

2. Fasten upper Cross Member to upper portion of rack rail. See Figure 3.

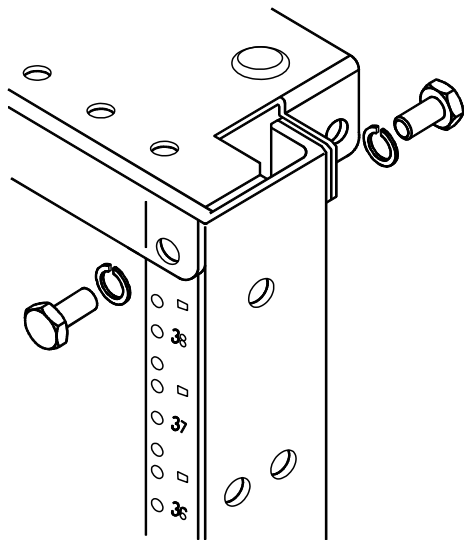
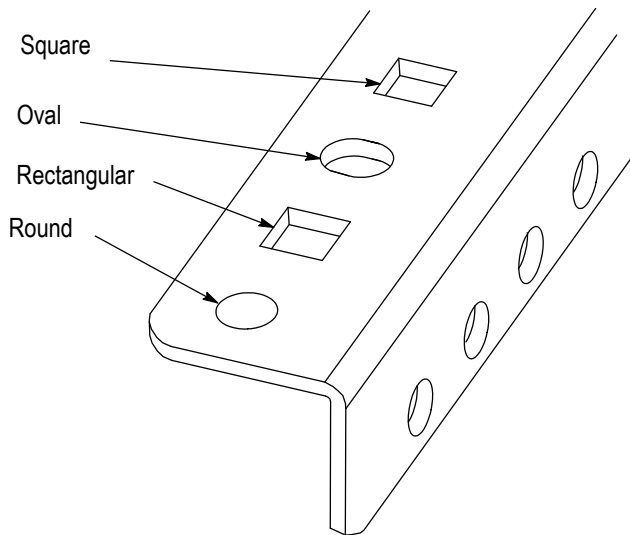

Figure 3

2.2. Adjustment Member to Frame Assembly

1. Use the table in Figure 4 to determine the hole combination for desired rack depth that corresponds to the rack part number. See Figure 4 for details.



HOLE COMBO	RACK DEPTH (mm [in.])
Square/Square	762 [30]
Square/Oval	787 [31]
Oval/Oval	813 [32]
Round/Rectangular	838 [33]
Rectangular/Rectangular	864 [34]
Rectangular/Round	889 [35]
Round/Round	914 [36]

Figure 4

2. Fasten the Lower Adjustment Member to the Lower Cross Member. See Figure 5. Repeat this step for all lower corners.

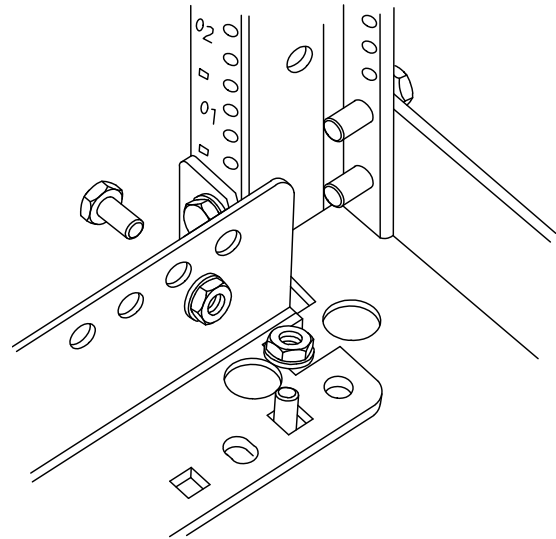

Figure 5

3. Fasten the Upper Adjustment Member to the Upper Cross Member. See Figure 6. Repeat this step for all upper corners.

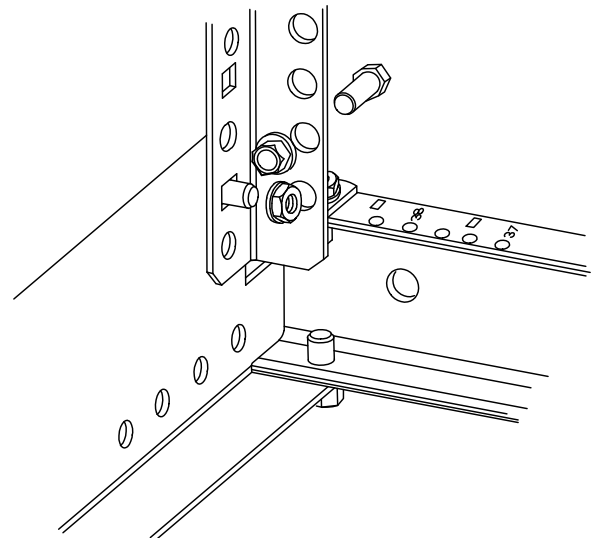

Figure 6

4. Torque all nuts and bolts to 27.12 Nm [20 ft-lbs].
 5. Stand rack up on base and position as desired.

3. REVISION SUMMARY

Revisions to this instruction sheet include:

- Rebranded to **CommScope**